

## 35 Series

### Model 35-51 Miniature Applicators

Change-up, quick and easy.

vanSCO's 35-51 Series Miniature Applicators offer quick and easy solutions to simplify a number of industry requirements. This compact and advanced design is proven to optimize production without a lot of downtime.

#### vanSCO's 35-51 Miniature Applicators features:

##### Speed

A diaphragm suspended actuating lever arm and construction is used to eliminate friction for fast, repeatable action. It can be used in low to very high speed applications.

##### Durability

A hardened valve needle and seat are used for extended valve life. A solid brass body with stainless-steel, nylon, UHMWPE, and Teflon® parts stand up better against rugged use. It is capable of 100 million cycles before replacement of internal parts.

##### Low Maintenance

A sealed tip reduces the possibility of adhesive drying in the valve. All component parts are easily accessible by removing two plugs and four screws.

##### Compact Design

A small package is used for easy installation and simple mounting in small spaces.

##### Unique Design

A unique diaphragm seal suspends the actuating lever, reducing friction created during actuation.

##### Applicator Variety

Three types of Applicator Valves are available. See the back page for more information.



How to order:	
	35-51-10 L/V 35-51-11 S/V 35-51-12 H/V
	35-51-20 L/V 35-51-21 S/V 35-51-22 H/V
	35-51-25 L/V 35-51-26 S/V 35-51-27 H/V
	35-51-30 L/V 35-51-31 S/V 35-51-32 H/V
	35-51-35 L/V 35-51-36 S/V 35-51-37 H/V
	35-52-00 L/V 35-52-01 S/V 35-52-02 H/V
	35-51-55 L/V 35-51-56 S/V 35-51-57 H/V MINI-SQUIRT
	35-51-60 L/V 35-51-61 S/V 35-51-62 H/V MINI-SPRAY

# 35-51 Series



## Squirt Applicator Valves

Used to squirt adhesive on a product under pressure. The adhesive is deposited in a single stream. No product contact is required.



## Extrusion Applicator Valves

Used to apply fine lines of adhesive on a product. Available for in-line sheet fed and in-line web fed mounting. Single outlet valves are also available for right angle actuator mounting. The dual outlet valves come with a choice of a 0.250" or 0.312" orifice spring. No product contact is required.



## Spray Applicator Valves

Used to spray the adhesive on a product. This is particularly useful when a thin adhesive film or fast tack time are required. Atomizing air control is required. No product contact is required.

## Technical Characteristics

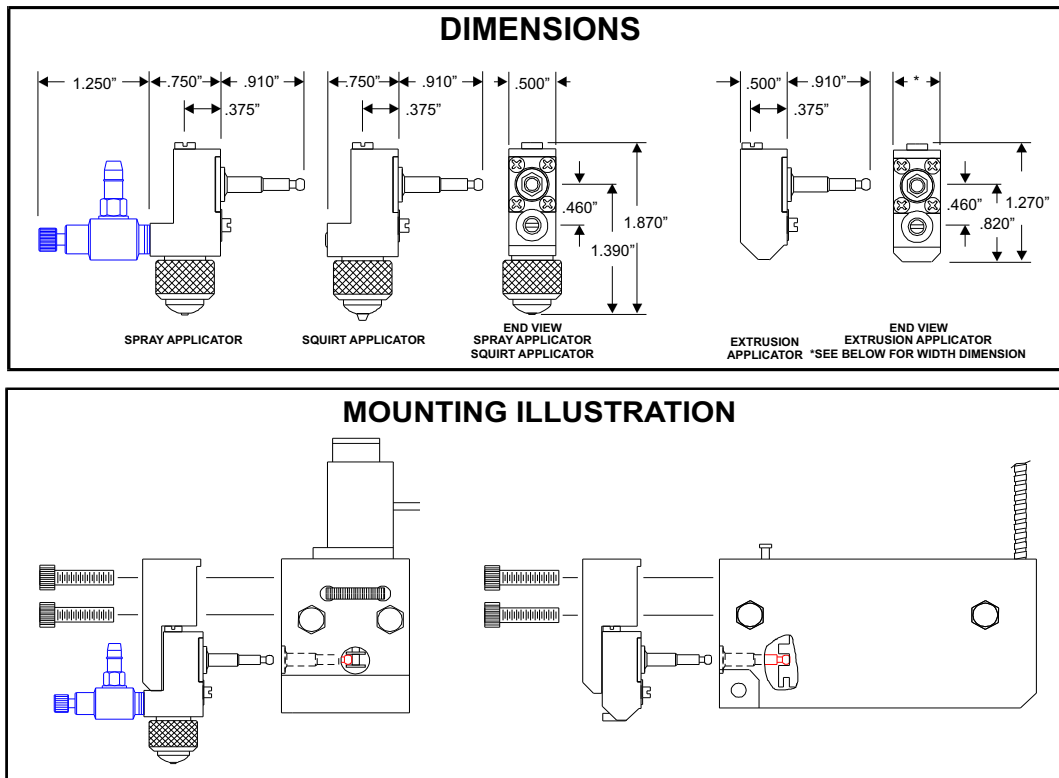

For more information visit [www.vansco.com](http://www.vansco.com) or contact us direct.



**VanSco Products**  
 2652 Lashbrook Avenue, South El Monte, CA 91733  
 Tel: 626.448.7611 / Fax: 626.448.0221  
[sales@vansco.com](mailto:sales@vansco.com)  
[www.vansco.com](http://www.vansco.com)



# 35-51 SERIES

# Miniature Applicators

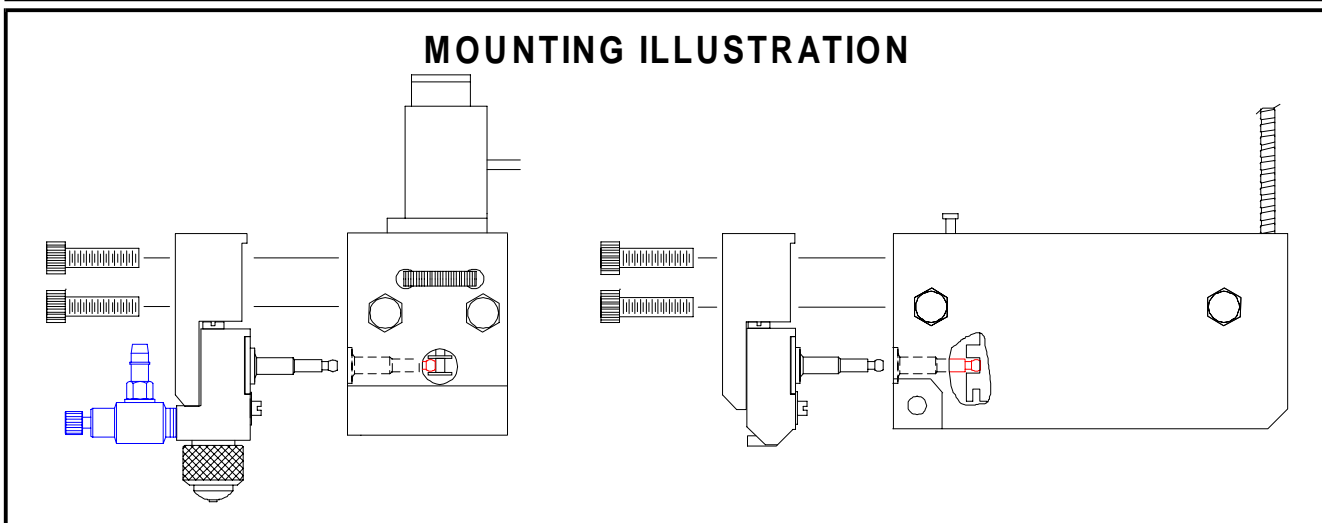
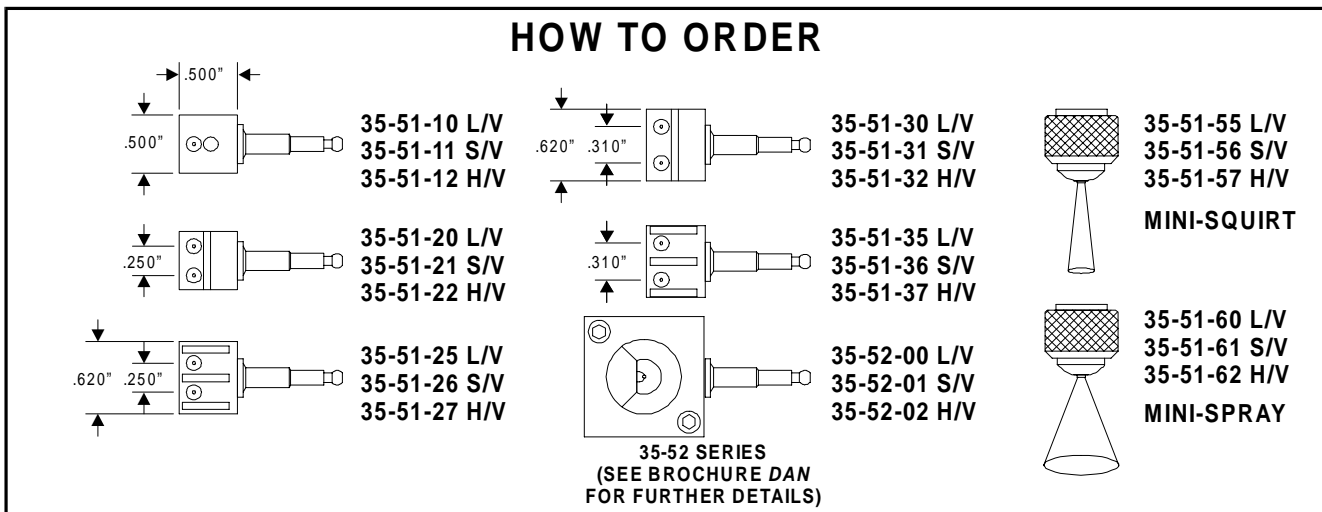
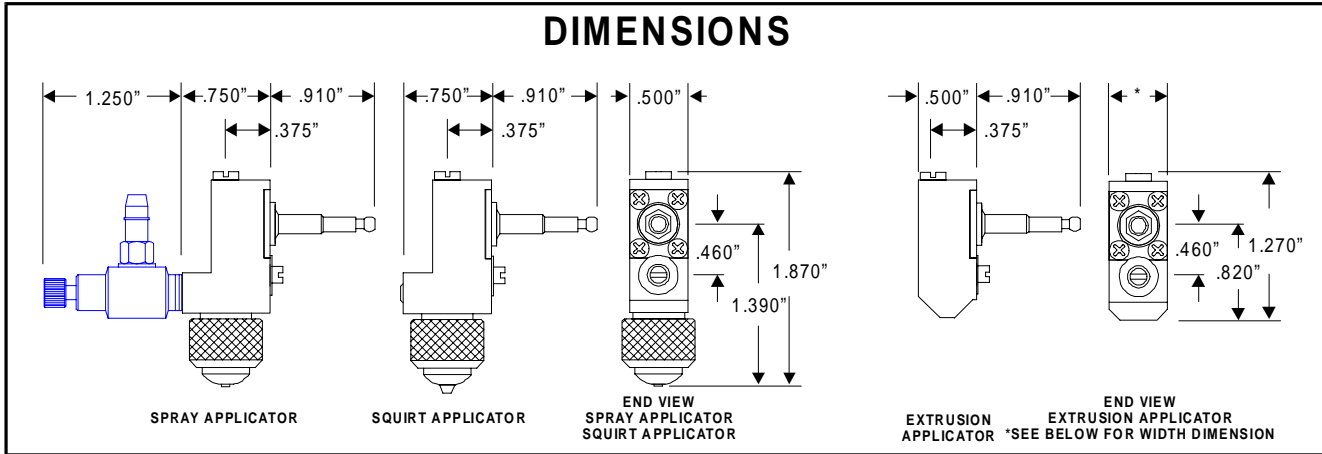

Distributed By:

DAK699

# COMPONENT PARTS

## Miniature Extrusion Type Applicator 35-51(-20, -21, -22, -30, -31, -32) Travers Rub Bar Model 35-51(-25, -26, -27, -35, -36, -37) In Line Rub Bar Model

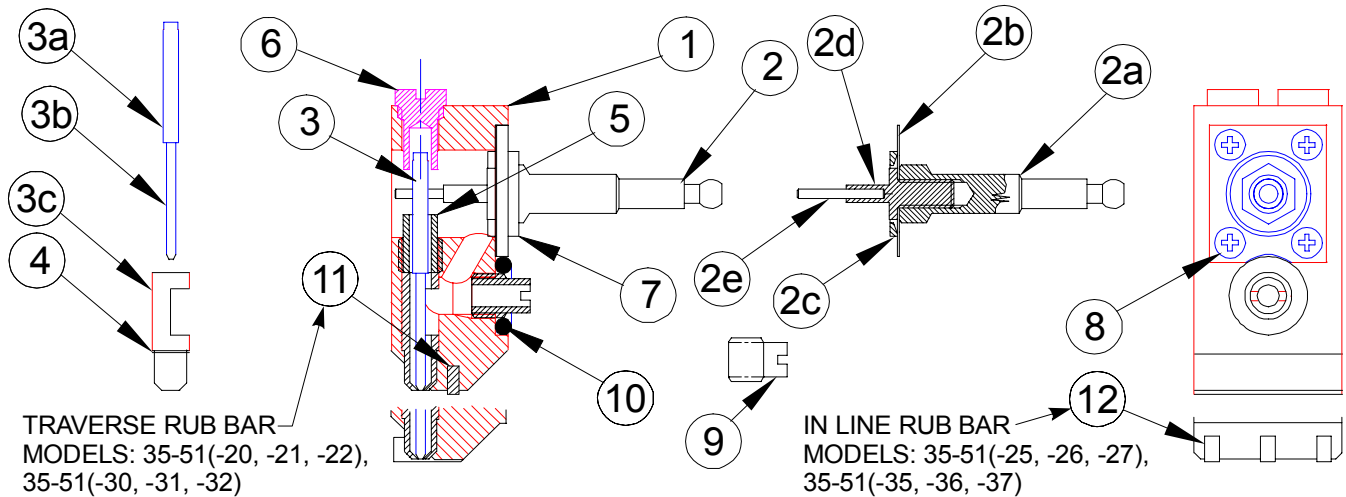

### ITEM PART NO. QTY DESCRIPTION

1	90-35-43	1	Valve Body (-20, -21, -22)
	90-35-44	1	Valve Body (-25, -26, -27)
	90-35-45	1	Valve Body (-30, -31, -32)
	90-35-46	1	Valve Body (-35, -36, -37)
2	90-35-35	1	Actuator Lever Assembly (Actuator Lever Assembly includes 2a through 2e)
2a	90-35-08	1	Actuating Lever
2b	90-35-32	1	Diaphragm
2c	90-35-15	1	Thrust Plate
2d	90-35-11	1	Actuating Fork
2e	90-35-23	2	Pin
3	90-35-38	2	Needle & Seat Assembly, L/V
	90-35-26	2	Needle & Seat Assembly, S/V
	90-35-39	2	Needle & Seat Assembly, H/V

### ITEM PART NO. QTY DESCRIPTION

(Needle & Seat Assembly includes 3a through 3c)			
3a	90-35-19	1	Needle Head
3b	90-35-20	1	Valve Needle
3c	90-35-36	1	Nozzle, L/V, 0.010
	90-35-12	1	Nozzle, S/V, 0.020
	90-35-37	1	Nozzle, H/V, 0.030
4	90-35-17	8	Seat Seal
5	90-35-14	3	Needle Guide
6	90-35-13	2	Valve End Plug
7	90-35-30	1	Diaphragm Retainer
8	90-07-12	4	1-72 x 3/16" Screw
9	90-35-31	1	Plug
10	90-07-01	1	O-Ring
11	90-35-21	1	Rub Bar (-00, -01, -02)
12	90-35-22	3	Rub Bar (-05, -06, -07)

#### ACTUATOR LEVER ASSEMBLY SERVICE KIT

Item 2: Actuator Lever Assembly is factory assembled.

90-35-35 Actuator Lever Assembly

#### NEEDLE & SEAT ASSEMBLY SERVICE KITS

Item 3: Needle and Seat Assembly is factory assembled and lapped as a set.

90-35-38 Needle & Seat Assembly, L/V

90-35-26 Needle & Seat Assembly, S/V

90-35-39 Needle & Seat Assembly, H/V

Distributed By:

**RECOMMENDED:** Use 90-35-17 Seat Seal with any of the above service kits.

DAS1299

# 35-51 Series Miniature Spray Applicator

## COMPONENT PARTS

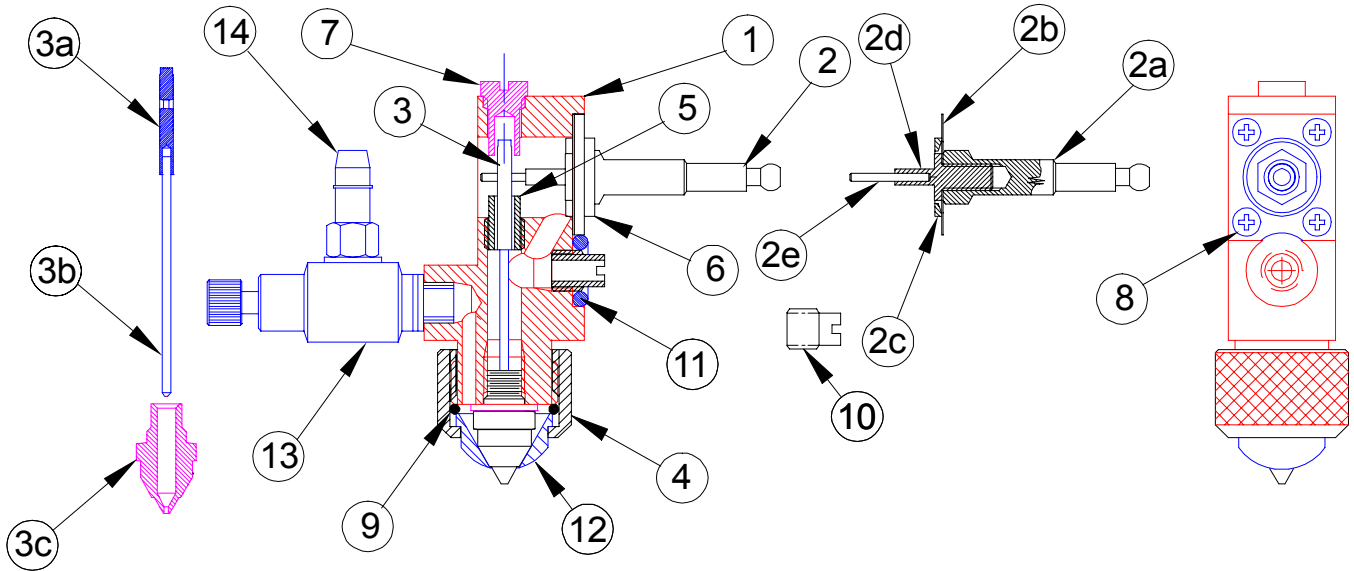

ITEM	PART NO.	QTY	DESCRIPTION
1	90-35-49	1	Applicator Valve Body
*2	90-35-33	1	Actuator Lever Assembly (Actuator Lever Assembly includes 2a through 2e)
2a	90-35-08	1	Actuating Lever
2b	90-35-32	1	Diaphragm
2c	90-35-15	1	Thrust Plate
2d	90-35-09	1	Actuating Fork
2e	90-35-23	1	Pin
*3	90-35-61	1	Needle & Seat Assembly, L/V
	90-35-62	1	Needle & Seat Assembly, S/V
	90-35-63	1	Needle & Seat Assembly, H/V
(Needle & Seat Assembly includes 3a through 3c)			
3a	90-35-19	1	Needle Head
3b	90-35-52	1	Valve Needle
3c	90-35-53	1	Spray Nozzle, L/V, 0.010
	90-35-54	1	Spray Nozzle, S/V, 0.020
	90-35-55	1	Spray Nozzle, H/V, 0.030
4	90-35-59	1	Air Nozzle Retaining Nut
5	90-35-14	2	Needle Guide
6	90-35-30	1	Diaphragm Retainer
7	90-35-13	1	Valve End Plug
8	90-07-12	4	1-72 x 3/16" Screw
9	90-02-33	1	O-Ring
10	90-35-31	1	Plug (Shipped Loose)
11	90-07-01	1	O-Ring
12	90-35-60	1	Air Nozzle
13	90-35-67	1	Atomizing Air Adj. Valve
14	90-06-98	1	Hose Barb

\*NOTE: Item 2 (90-35-33) is shipped factory assembled.

Item 3 (90-35-26) is shipped factory assembled with Needle and Nozzle lapped as a set.

Distributed By:

DAO1199

VanSco Products - The Gluing Equipment Innovators  
 2652 Lashbrook Avenue • South El Monte, CA 91733 • 626-448-7611 • Fax 626-448-0221  
 E-mail: sales@vansco.com • URL: www.vansco.com

**vanSco**®

# 35-51 Series Miniature Squirt Applicator

## COMPONENT PARTS

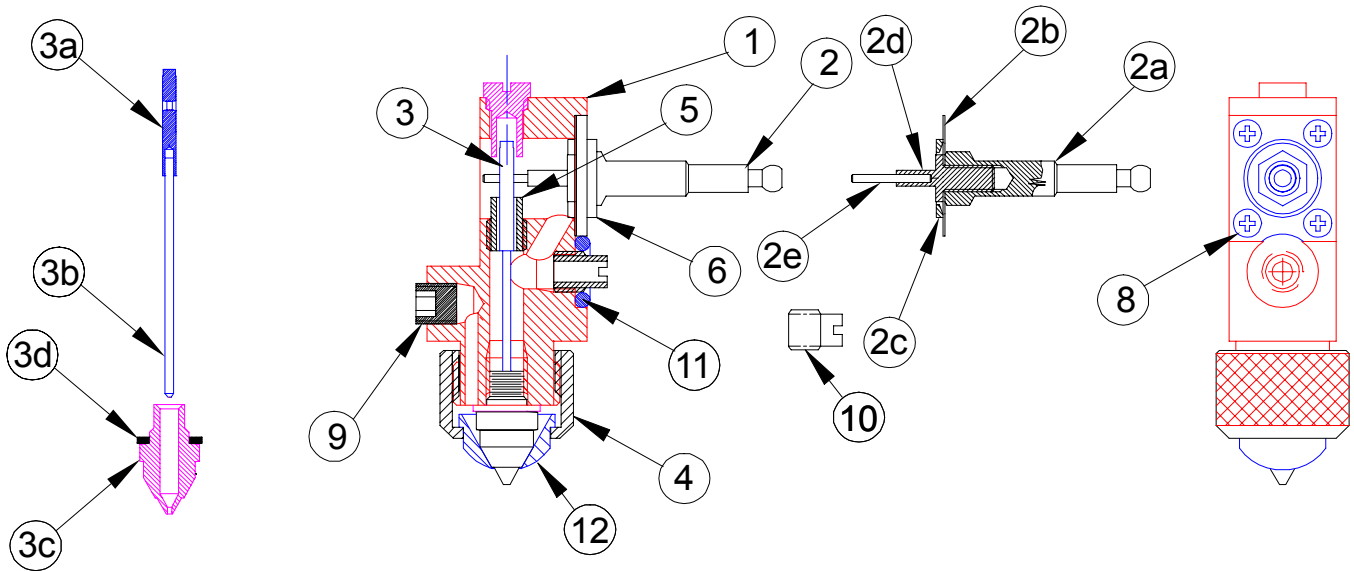

ITEM	PART NO.	QTY	DESCRIPTION	ITEM	PART NO.	QTY	DESCRIPTION
1	90-35-49	1	Applicator Valve Body	4	90-35-59	1	Air Nozzle Retaining Nut
*2	90-35-33	1	Actuator Lever Assembly (Actuator Lever Assembly includes 2a through 2e)	5	90-35-14	2	Needle Guide
2a	90-35-08	1	Actuating Lever	6	90-35-30	1	Diaphragm Retainer
2b	90-35-32	1	Diaphragm	7	90-35-13	1	Valve End Plug
2c	90-35-15	1	Thrust Plate	8	90-07-12	4	1-72 x 3/16" Screw
2d	90-35-09	1	Actuating Fork	9	90-02-49	1	10-32 x 3/16" Set Screw
2e	90-35-23	1	Pin	10	90-35-31	1	Plug (Shipped Loose)
*3	90-35-64	1	Needle & Seat Assembly, L/V	11	90-07-01	1	O-Ring
*3	90-35-65	1	Needle & Seat Assembly, S/V	12	90-35-70	1	Nozzle Cover
*3	90-35-66	1	Needle & Seat Assembly, H/V (Needle & Seat Assembly includes 3a through 3d)				
3a	90-35-19	1	Needle Head				
3b	90-35-52	1	Valve Needle				
3c	90-35-56	1	Squirt Nozzle, L/V, 0.010				
	90-35-57	1	Squirt Nozzle, S/V, 0.020				
	90-35-58	1	Squirt Nozzle, H/V, 0.030				
3d	90-35-71	1	Gasket				

**\*NOTE:** Item 2 (90-35-33) is shipped factory assembled.  
Item 3 (90-35-26) is shipped factory assembled with Needle and Nozzle lapped as a set.

Distributed By:

DAO1199

VanSCO Products - The Gluing Equipment Innovators  
2652 Lashbrook Avenue • South El Monte, CA 91733 • 626-448-7611 • Fax 626-448-0221  
E-mail: sales@vansco.com • URL: www.vansco.com





# 35 Series

## Model 35-52 Smooth Nose Valve

Quality, high-speed precision.

**vanSCO**'s high-speed **35-52 Smooth Nose Valve** offers a unique design for durable and rapid placement. The 35-52 valve attaches to the actuator with a single screw to provide easy assembly and disassembly. A push fitting is also included at the adhesive inlet for an easy installation. Its compact design allows the valve to fit easily into tight places to meet a range of industry needs.

### **vanSCO**'s 35-52 Smooth Nose Valve features:

#### **Fastest and Most Accurate Valve**

Combined with the VanSCO® 40-40-02 Actuator, the 35-52 series valve offers fast and accurate adhesive placement.

#### **Optimal Gluing**

Light product contact during application allows smearing of the adhesive directly onto the substrate to maximize absorption into the fiber for a secure bond.

#### **High Performance**

Direct mechanical actuation is automatically opened and closed by the actuator for consistent, repeatable performance. Low weight moving parts minimize valve inertia and maximize valve speed.

#### **Versatile Mount**

The one-piece valve seat and application head can be mounted on the valve body at 90-degree increments, allowing the attached actuator to be positioned as required for in-line product travel.

#### **Unique Design**

A unique diaphragm seal suspends the actuating lever that reduces actuation friction.

#### **Durability**

A hardened valve seat is used for extended valve life. All wetted parts are brass, stainless-steel, and UHMW polyethylene.

#### **Compact Design**

A small package means easy installation and mounting adaptability.

#### **Zero Cavity for Increased Quality**

A sealed tip reduces the possibility of adhesive drying in the valve.

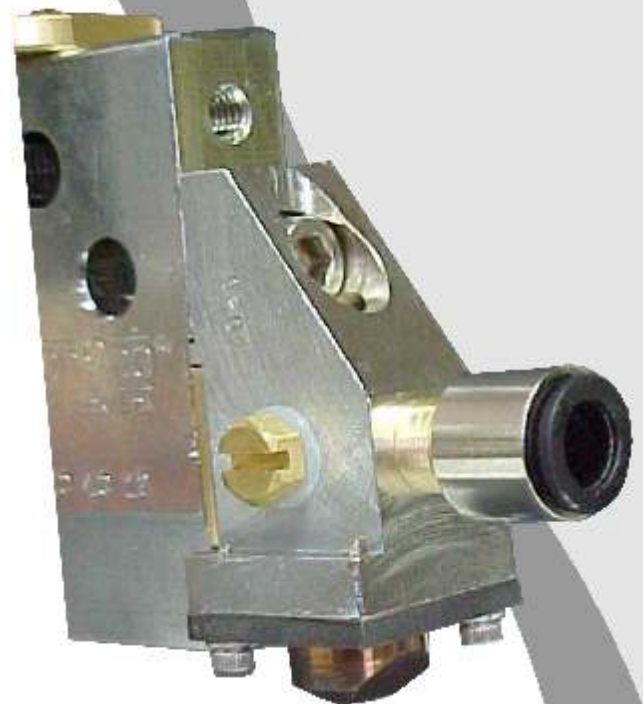

# 35-52 Series Valve

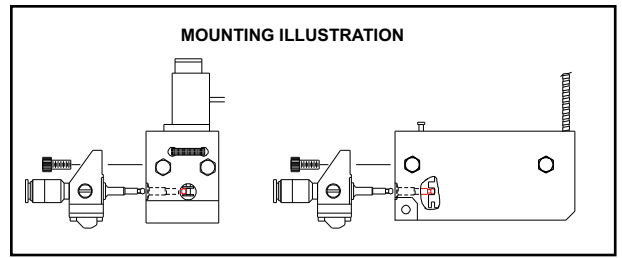
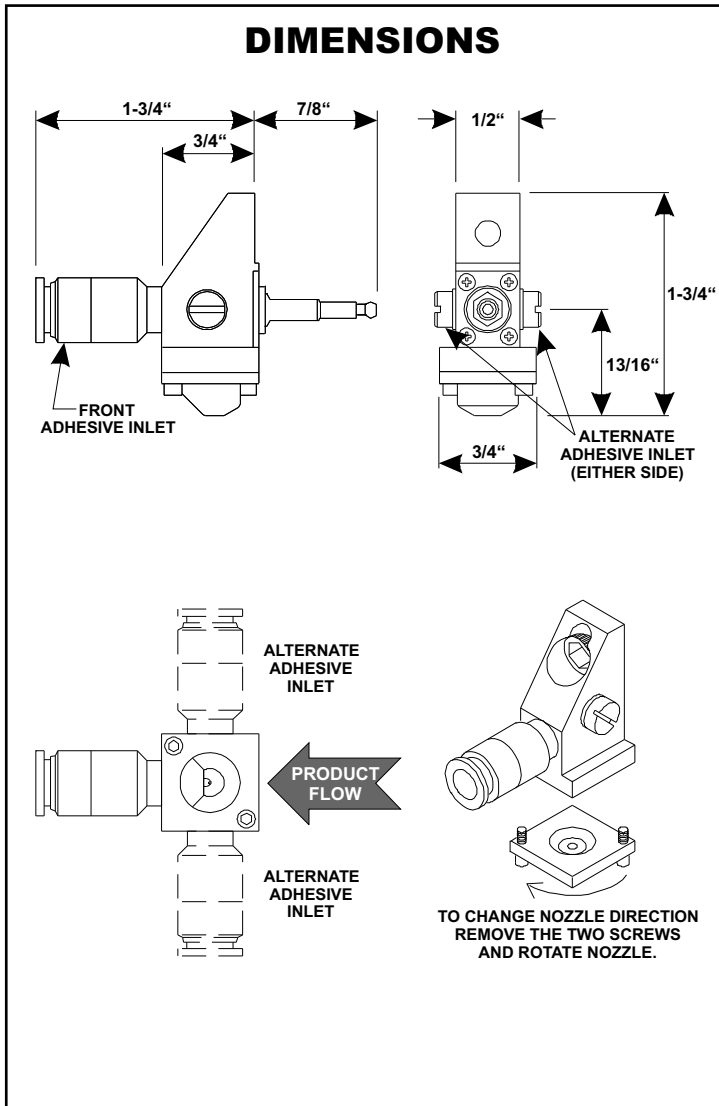

Applicators are shipped with a mounting screw (part number 90-07-05) that is used to mount the valve to the actuator.

## Service Kits:

Part Number	Description
90-35-80	Needle and seat assembly, L/V
90-35-81	Needle and seat assembly, R/H
90-35-82	Needle and seat assembly, H/V
90-35-33	Actuating lever assembly

## How to order:

Part Number	Description
35-52-00	Smooth nose, low volume, 0.010" orifice
35-52-01	Smooth nose, standard volume, 0.020" orifice
35-52-02	Smooth nose, high volume, 0.030" orifice

## Technical Characteristics

<b>35-52 Series Specifications</b>	
<b>Fluid pressure:</b>	Up to 65 psi fluid pressure
<b>Fluid viscosity range:</b>	200-2,000 centipoise
<b>Construction:</b>	All wetted parts are brass, stainless-steel, nylon, and UHMWPE
<b>Fluid inlet:</b>	1/4" OD Tube x 10-32 push fitting

For more information visit [www.vansco.com](http://www.vansco.com) or contact us direct.



**VanSco Products**  
2652 Lashbrook Avenue, South El Monte, CA 91733  
Tel: 626.448.7611 / Fax: 626.448.0221  
sales@vansco.com  
www.vansco.com





# 35-52 Series Miniature Universal Applicator

## COMPONENT PARTS

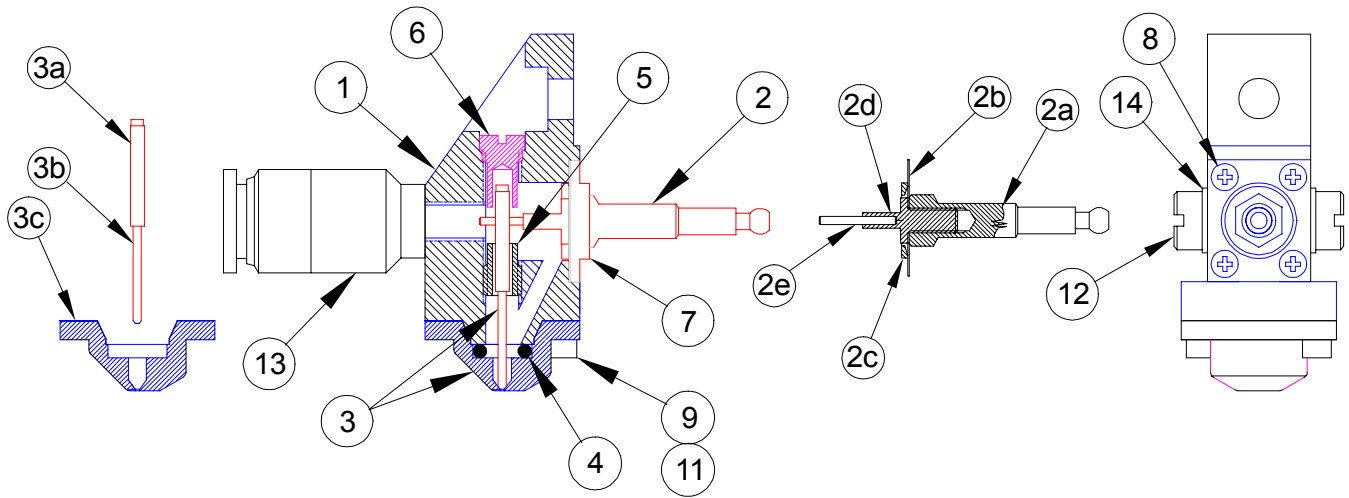

### ITEM PART NO. QTY DESCRIPTION

1	90-35-75	1	Applicator Valve Body
2	90-35-33	1	Actuator Lever Assembly (Actuator Lever Assembly includes 2a through 2e)
2a	90-35-08	1	Actuating Lever
2b	90-35-32	1	Diaphragm
2c	90-35-15	1	Thrust Plate
2d	90-35-09	1	Actuating Fork
2e	90-35-23	1	Pin
3	90-35-80	1	Needle & Seat Assembly, L/V
	90-35-81	1	Needle & Seat Assembly, S/V
	90-35-82	1	Needle & Seat Assembly, H/V
			(Needle & Seat Assembly includes 3a through 3c)
3a	90-35-19	1	Needle Head
3b	90-35-20	1	Valve Needle

### ITEM PART NO. QTY DESCRIPTION

3c	90-35-76	1	Squirt Nozzle, L/V, 0.010
	90-35-77	1	Squirt Nozzle, S/V, 0.020
	90-35-78	1	Squirt Nozzle, H/V, 0.030
4	90-07-64	1	O-Ring, Buna N
5	90-35-14	2	Needle Guide
6	90-35-83	1	Valve End Plug
7	90-35-30	1	Diaphragm Retainer
8	90-07-12	4	1-72 x 3/16" Screw
9	90-07-65	2	2-56 x 1/4", SHCS, S.S.
10	90-07-05	1	10-32 x 3/8", SHCS
11	90-07-66	2	#2 Split Lock Washer
12	90-46-29	2	10-32 Plug (Includes Item 14)
13	90-07-37	1	10-32 x 1/4" Push Fitting
14	90-46-28	2	Gasket

#### ACTUATOR LEVER ASSEMBLY SERVICE KIT

Item 2: Actuator Lever Assembly factory assembled.

90-35-33      Actuator Lever Assembly

#### NEEDLE & SEAT ASSEMBLY SERVICE KITS

Item 3: Needle and Seat Assembly is factory assembled and lapped as a set.

90-35-80      Needle & Seat Assembly, L/V  
 90-35-81      Needle & Seat Assembly, S/V  
 90-35-82      Needle & Seat Assembly, H/V

Distributed By:

DAQ999

VanSco Products - The Gluing Equipment Innovators  
 2652 Lashbrook Avenue • South El Monte, CA 91733 • 626-448-7611 • Fax 626-448-0221  
 E-mail: sales@vansco.com • URL: www.vansco.com

**vanSco**®

## 35 SERIES TECHNICAL & SERVICE MANUAL

### PRINCIPLES OF OPERATION:

All applicator valves are designed to mount on the 40-40 series actuators. The actuator moves the actuating lever downward which lifts the needle from the seat and allows adhesive to flow. Upward movement of the actuating lever closes the valve.

### ADHESIVE SUPPLY REQUIREMENTS:

#### Adhesive Supply Pressure Requirements:

Constant, unvarying adhesive pressure  
 Pressure Range: 0 to 65 psig  
 Typical System Pressure: 10-30 psig

#### Adhesive Filtration Requirements: 100 mesh

#### Adhesive Viscosity Recommendations:

Viscosity Range: 0 to 1,500 cps  
 Extrusion Viscosity: 500-1,500 cps  
 Squirt Viscosity: 200-1,000 cps  
 Spray Viscosity: 200-1,000 cps

#### Adhesive Composition Requirements:

Recommended Adhesive Type: water based resin emulsion  
**Stainless Steel model required for natural rubber latex emulsion**

### SUBSTRATE & BACKUP MOUNTING REQUIREMENTS:

Extrusion: Designed for light substrate contact, compression applications where accurate pattern placement is critical. There are two different types of extrusion valves designed for the continuous web application and the individual sheet fed application:

35-52 series actuator provides a positive substrate position.

Spray: Designed for non-contact, fast tack time applications. A fixed substrate position must be maintained in order to create a consistent spray pattern. The typical spray valve to substrate distance is one inch, but it will vary with adhesive application pressure, adhesive composition, adhesive viscosity, and atomizing air pressure.

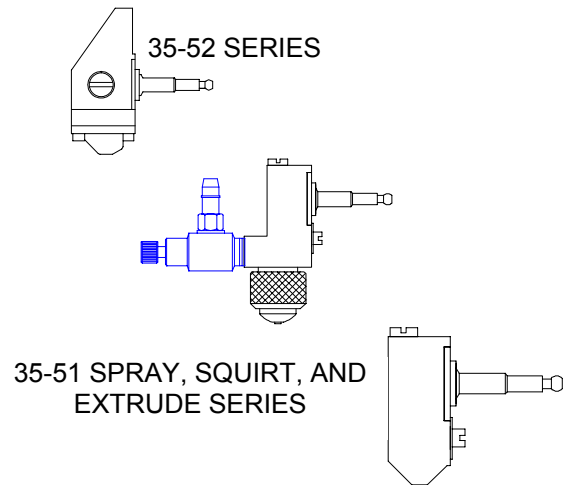

Illustration 1-1  
**35-51 & 35-52 SERIES**

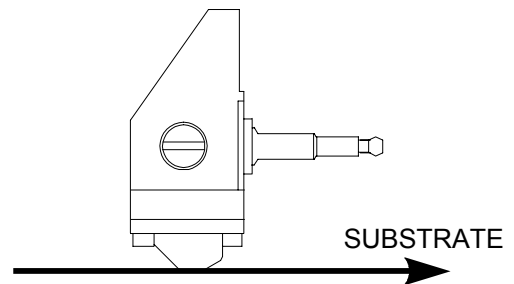

Illustration 1-2  
**35-52 SERIES CONTACT WITH SUBSTRATE**

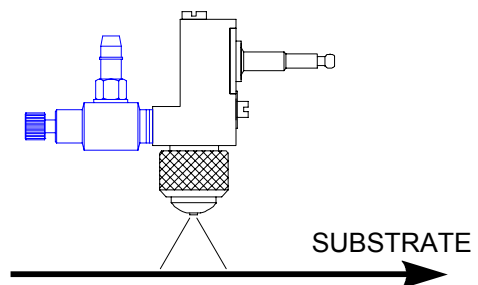

Illustration 1-3  
**35-51 SERIES SPRAY WITH SUBSTRATE**

Squirt: Designed for non-contact compression application. A fixed substrate position must be maintained in order to create a consistent squirt pattern. The typical squirt valve to substrate distance is one half of one inch, but it will vary with adhesive application pressure, adhesive composition, and adhesive viscosity

## OUTPUT RESULTS:

### Reaction Time:

Direct mechanical actuation means the valve response time is directly proportional to the actuator response time. The only delays are due to the dynamic viscous properties of the adhesive, and inertial properties of the actuator and valve.

### Fluid Output Adjustment:

Fluid output adjustment is controlled by the adhesive pressure and the 40-40 series actuator onto which the applicator valve is installed. See 40-40 series technical manual for more information. **Note:** Limiting the stroke of the applicator valve can dramatically change both the pattern volume and the pattern cutoff accuracy. The dynamic viscous properties of some adhesives require a fine applicator valve adjustment to eliminate the adhesive cutoff filament trailing, or flooding of the valve at the trailing edge of the pattern in order to achieve the desired pattern.

## MAINTENANCE:

### Initial Startup, Running Production, Shutdown, and Restart:

Startup: All fluid and air lines must be clear of foreign material prior to running production. It is recommended to purge the air line with clean, dry, un-lubricated air; and it is recommended to purge the adhesive lines with the adhesive that is to be used for production prior to installation of the applicator valve. After installation of the applicator valve, the entire adhesive section should be purged of all air pockets. This can be achieved by repeatedly cycling the valve while holding it higher than the adhesive supply lines and applying 20 to 30 psi adhesive pressure.

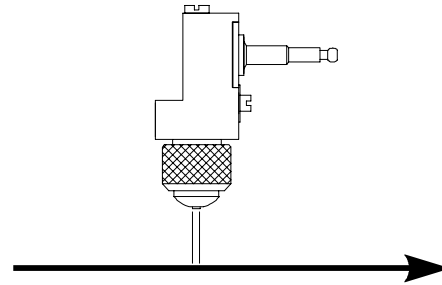

Illustration 1-4

### 35-51 SERIES SQUIRT WITH SUBSTRATE

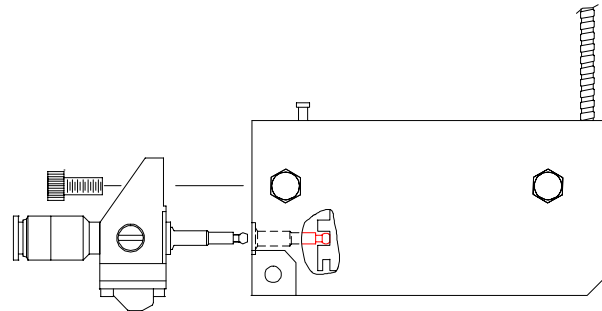

Illustration 1-5

### 35-52 SERIES WITH 40-40-02 ACTUATOR

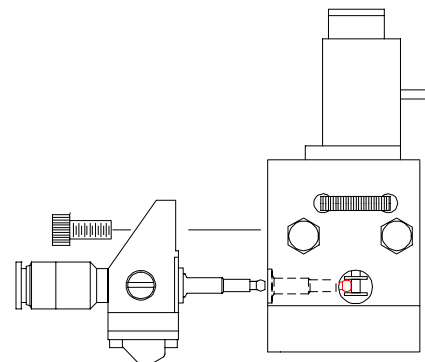

Illustration 1-6

### 35-52 SERIES WITH 40-40-12 ACTUATOR

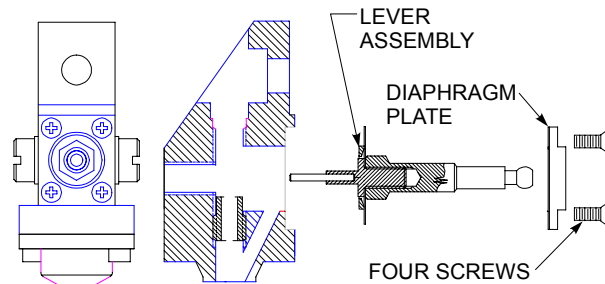

Illustration 1-7

### REMOVING LEVER ASSEMBLY

## REPAIR & REBUILD GUIDE:

### Extrusion Valve, Rebuild:

#### Installation of 35-51 Series Service Kits:

1. Remove four screws in diaphragm plate then remove entire lever assembly (*Illustration 1-8*).
2. Remove valve end plug from valve end opposite outlet.
3. Remove needle through valve end plug hole.
4. Using a narrow, flat head screwdriver, remove needle guide from inside of the valve body. The needle guide holds the valve seat in place and can be accessed through the valve end plug hole (*Illustration 1-8*).
5. Remove valve seat by forcing it up through valve end plug hole. **CAUTION:** A variable number of seat seal shims may or may not come out of the valve with the valve seat. They are 0.003" thick, so be aware. These seat seals are critical for both valve seal and outlet-to-substrate standoff distance.
6. Install new valve seat and needle guide while making certain the same number of seat seals are between valve seat and body.
7. Install needle guide and measure valve outlet-to-rub bar standoff distance (0.010 +/- 0.002"). If this distance is incorrect, add or remove seat seals as needed.
8. Install new needle, valve end plug, lever assembly, and diaphragm plate.

#### Installation of 35-52 Series Service Kits:

1. Disassemble valve as described in steps one through three above.
2. Remove valve seat by removing the two hex head screws (*Illustration 1-9*).
3. Inspect the O-Ring and replace with part number 90-07-64 if needed.
4. Install new valve seat in place with the two screws then install the new needle in place. **NOTE:** The needle and seat assembly, ordered as a service kit, is factory lapped as a pair and should be installed as a pair. If not, you must lap the needle to the seat to insure a no-leak fit.
5. Install valve end plug, lever assembly, and diaphragm plate.

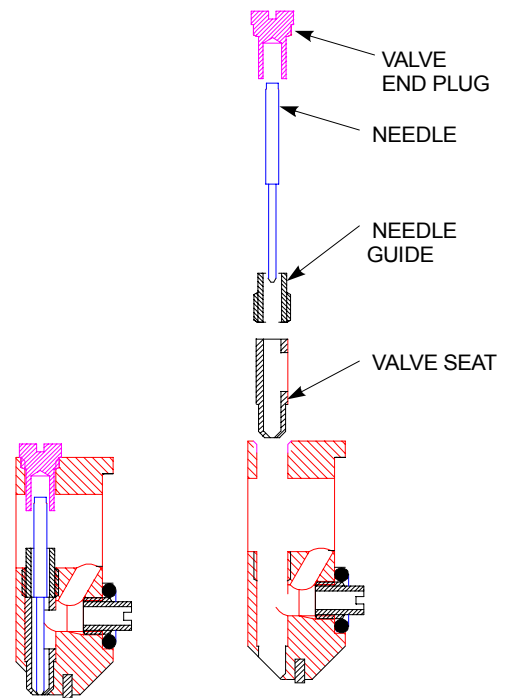

*Illustration 1-8*  
**35-51 EXTRUSION VALVE**

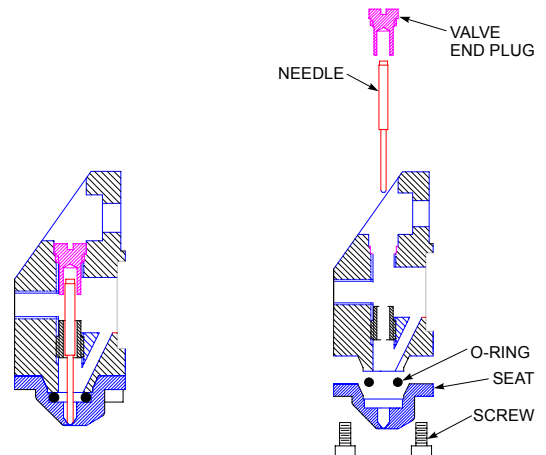

*Illustration 1-9*  
**35-52 CONTACT VALVE**

**Spray & Squirt Valves, Rebuild:**

1. Remove nozzle cover, nozzle, and seat from valve; the spray valve requires unscrewing the seat from the valve body (*Illustration 1-10*).
2. Remove four screws in diaphragm plate then remove entire lever assembly (*Illustration 1-7*).
3. Remove valve end plug from valve end opposite outlet.
4. Remove needle through valve end plug hole.
5. Install new seat and needle. **NOTE:** The needle and seat assembly, ordered as a service kit, is factory lapped as a pair and should be installed as a pair. If not, you must lap the needle to the seat to insure a no-leak fit.
6. Re-install valve end plug, lever assembly, diaphragm plate, four screws (*Illustration 1-7*), nozzle, nozzle cover, and nozzle retaining nut.

**LEVER ASSEMBLY**

Whenever the lever assembly (*Illustration 1-7*) is re-installed it must be adjusted so that at *no power* the needle is in a closed position with the lever shaft at 90° to the valve body.

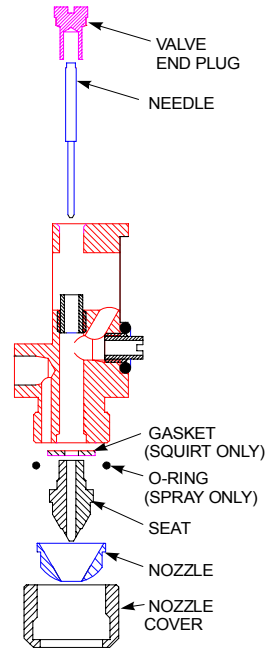

*Illustration 1-10*  
**35-51 SQUIRT/SPRAY VALVE**

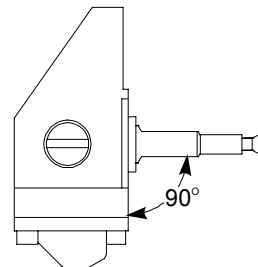

*Illustration 1-11*  
**LEVER ASSEMBLY 90° TO VALVE BODY**

**TROUBLESHOOTING GUIDE**

<b>PROBLEM</b>	<b>CAUSE</b>	<b>SOLUTION</b>
No adhesive flow or valve is slow to open	Valve installed incorrectly	Install actuating lever in saddle. (See Illustrations 1-5 & 1-6)
	Actuator malfunction	Check actuator movement.
	Adhesive flow restricted	Open fluid control
	Plugged valve seat	Remove foreign debris or dried adhesive from valve
Adhesive does not shut off or valve is slow to close	Broken fork pin or actuating lever	Replace actuating lever assembly
	Adhesive build up or foreign material in valve seat	Remove foreign debris or dried adhesive from valve seat
	Actuator malfunction	Check actuator movement
	Needle and valve seat damage due to excessive wear	Replace needle and seat assembly (See chart page 1-6)
Not enough adhesive	Broken fork pin or actuating lever	Replace actuating lever assembly
	Coagulated adhesive forming in applicator valve	Remove valve from actuator and thoroughly clean
	Adhesive flow restricted	Open fluid control
	Adhesive pressure too low	Increase fluid pressure
Too much adhesive	Plugged strainer/filter in adhesive supply	Clean or replace strainer/filter element
	Coagulated adhesive forming in applicator valve	Remove valve from actuator and thoroughly clean valve
	Adhesive build up or foreign material in valve seat	Remove foreign debris or dried adhesive from valve seat
	Incorrect choice of outlet volume	Consult factory for valve with other size outlet volume
Unbalance, distorted, or erratic adhesive pattern	Valve wide open	Adjust fluid control
	Adhesive pressure too high	Decrease fluid pressure
	Incorrect choice or outlet volume	Consult factory for valve with higher outlet volume
Single shot or drop of adhesive as valve closes	Adhesive build up on valve seat or air nozzle	Remove dried adhesive from valve seat or air nozzle
	Extrusion valve not in contact with substrate	Increase valve to substrate contact pressure or install spring backup
	Inconsistent substrate	Install machine guides to maintain consistent substrate position
Rapid adhesive nozzle flow build up	Too much atomizing air for spray	Decrease atomizing air flow
	Incorrect mounting position for spray	Make certain valve is perpendicular to substrate
Spray pattern too narrow	Needle pumping adhesive as valve closes	Increase fluid pressure and reduce valve stroke length
	Not enough atomizing air for spray pattern	Increase atomizing air
Spray pattern too wide	Contamination or improper adhesive being used	Consult adhesive supplier for assistance
	Spray valve mounted too close to substrate	Increase valve to substrate distance
Valve trailing at shutoff	Spray valve mounted too far to substrate	Decrease valve to substrate distance
	Adhesive build up on valve seat or air nozzle	Remove dried adhesive from valve seat or air nozzle
	Contaminated or improper adhesive being used	Consult adhesive supplier for assistance



## 35-51 & 35-52 SERIES REPLACEMENT ASSEMBLIES

<b>35-XX-XX Part No.</b>	<b>*Needle &amp; Seat Ass'y</b>	<b>**Actuating Lever Ass'y</b>	<b>Description</b>
35-51-00	90-35-38	90-35-33	Single Vein Continuous Web L/V
35-51-01	90-35-26	90-35-33	Single Vein Continuous Web S/V
35-51-02	90-35-39	90-35-33	Single Vein Continuous Web H/V
35-51-05	90-35-38	90-35-33	Single Vein Sheet Fed L/V
35-51-06	90-35-26	90-35-33	Single Vein Sheet Fed S/V
35-51-07	90-35-39	90-35-33	Single Vein Sheet Fed H/V
35-51-10	90-35-38	90-35-33	Single Vein Continuous Web L/V
35-51-11	90-35-26	90-35-33	Single Vein Continuous Web S/V
35-51-12	90-35-39	90-35-33	Single Vein Continuous Web H/V
35-51-20	90-35-38	90-35-34	Dual Vein, 1/4" Centers, Continuous Web L/V
35-51-21	90-35-26	90-35-34	Dual Vein, 1/4" Centers, Continuous Web S/V
35-51-22	90-35-39	90-35-34	Dual Vein, 1/4" Centers, Continuous Web H/V
35-51-25	90-35-38	90-35-34	Dual Vein, 1/4" Centers, Sheet Fed L/V
35-51-26	90-35-26	90-35-34	Dual Vein, 1/4" Centers, Sheet Fed S/V
35-51-27	90-35-39	90-35-34	Dual Vein, 1/4" Centers, Sheet Fed H/V
35-51-30	90-35-38	90-35-35	Dual Vein, .310" Centers, Continuous Web L/V
35-51-31	90-35-26	90-35-35	Dual Vein, .310" Centers, Continuous Web S/V
35-51-32	90-35-39	90-35-35	Dual Vein, .310" Centers, Continuous Web H/V
35-51-35	90-35-38	90-35-35	Dual Vein, .310" Centers, Sheet Fed L/V
35-51-36	90-35-26	90-35-35	Dual Vein, .310" Centers, Sheet Fed S/V
35-51-37	90-35-39	90-35-35	Dual Vein, .310" Centers, Sheet Fed H/V
35-51-40	90-35-38	90-35-33	Single Vein Left Hand Sheet Fed L/V
35-51-41	90-35-26	90-35-33	Single Vein Left Hand Sheet Fed S/V
35-51-42	90-35-39	90-35-33	Single Vein Left Hand Sheet Fed H/V
35-51-45	90-35-38	90-35-33	Single Vein Right Hand Sheet Fed L/V
35-51-46	90-35-26	90-35-33	Single Vein Right Hand Sheet Fed S/V
35-51-47	90-35-39	90-35-33	Single Vein Right Hand Sheet Fed H/V
35-51-60	90-35-61	90-35-33	Mini-Spray L/V
35-51-61	90-35-62	90-35-33	Mini-Spray S/V
35-51-62	90-35-63	90-35-33	Mini-Spray H/V
35-51-55	90-35-64	90-35-33	Mini-Squirt L/V
35-51-56	90-35-65	90-35-33	Mini-Squirt S/V
35-51-57	90-35-66	90-35-33	Mini-Squirt H/V
<b>35-52-00</b>	<b>90-35-80</b>	<b>90-35-33</b>	<b>Smooth Nose, Universal Applicator, L/V</b>
<b>35-52-01</b>	<b>90-35-81</b>	<b>90-35-33</b>	<b>Smooth Nose, Universal Applicator, S/V</b>
<b>35-52-02</b>	<b>90-35-82</b>	<b>90-35-33</b>	<b>Smooth Nose, Universal Applicator, H/V</b>
90-35-32	Diaphragm		

\*90-35-17 Seat Seal recommended for each Needle & Seat Assembly replacement and must be ordered separately.  
(Not used on Spray, Squirt and 35-52 valves).

\*\*Actuating Lever Assembly includes: Valve Lever, Diaphragm, Thrust Plate, Actuating Fork and Pin.